



45 Above Town, Upper Clatford, Andover, SP11 7QA
Asking Price £365,000



45 Above Town, Upper Clatford Andover, Asking Price £365,000

PROPERTY DESCRIPTION BY Mr Guy Sommerville

This delightful three-bedroom semi-detached home is situated in the heart of Upper Clatford – a charming Hampshire village known for its sense of community, countryside surroundings, and close proximity to Andover town centre. Internally, the property has been tastefully updated by the current owners to offer a stylish and welcoming home ready to move into. The front-facing kitchen is both functional and fashionable, featuring modern cabinetry with clever storage solutions and a smart, efficient layout. The real showpiece is the spacious triple-aspect living/dining room, which is flooded with natural light thanks to windows to the front, side, and rear. Patio doors lead directly to a sunny, south-facing garden, providing an ideal space for entertaining or relaxing. Upstairs, there are three bedrooms and a beautifully finished bathroom. The bathroom benefits from a clever pocket door, which enhances both practicality and space. Significant improvements include a full re-wire, hard-wired smoke alarms and a new roof. The detached garage has been upgraded with power and lighting, and is attractively finished with timber batten cladding. To the rear of the garage is an additional storage shed, perfect for garden tools or bikes. The rear garden is enclosed by timber fencing and features a patio area directly off the back of the house. Gated side access leads to the private driveway, which comfortably accommodates two vehicles. Backing onto the village hall grounds, this home offers privacy, peaceful surroundings, and access to beautiful country walks – all while being just a short distance from Andover's amenities, transport links, and schools.





Upper Clatford

Upper Clatford is an extremely picturesque village situated in the Anton Valley. There are a wealth of thatched cottages all set within a convenient location close to open countryside, Andover Town and the A303. The village has an attractive thatched pub, beautiful and tranquil 12th century church set beside a water meadow and thriving village hall with numerous community groups. Nearby Goodworth Clatford has a village primary school and popular village store.



Above Town, SP11

Approximate Gross Internal Area = 70.3 sq m / 757 sq ft
Garage = 13.6 sq m / 146 sq ft
Total = 83.9 sq m / 903 sq ft

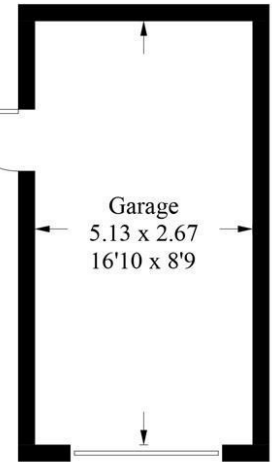
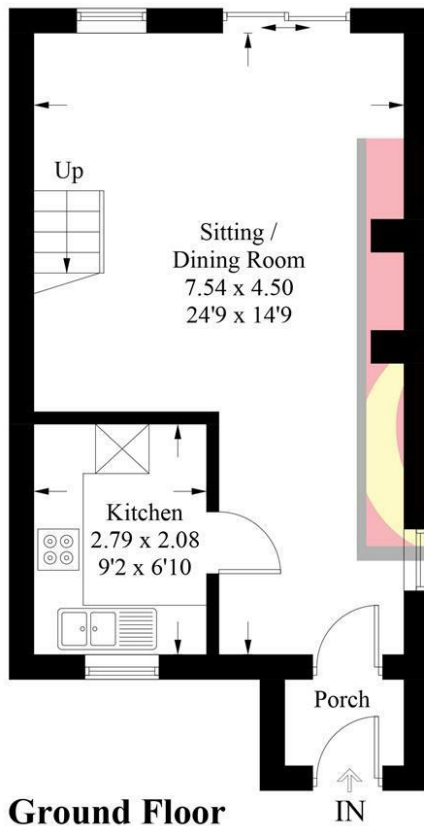

(Not Shown In Actual Location / Orientation)

PRODUCED FOR GRAHAM AND CO

Whilst every attempt has been made to ensure the accuracy of the floorplan, measurements of doors, windows and rooms are approximate. These plans are for representation purposes only as defined by RICS Code of Measuring Practice and used as such by any prospective purchaser. © Emzo Marketing (ID1207219)

MORTGAGE ADVICE

Across The Market Mortgages

An independent Mortgage brokerage offering expert advice from across the whole market. Whether you are a first-time buyer, home mover, remortgaging or buying a Buy-To-Let investment. Tristan can provide expert & reliable advice, in a clear jargon free language. Book a free consultation today.

E - tristan@atmmortgages.com M - 07545320380

www.atmmortgages.com

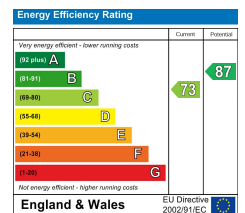

Tax Band: C



OPEN 7 DAYS

If you are considering selling your home please contact us today for your free no obligation valuation

01264 356500

IMPORTANT: we would like to inform prospective purchasers that these sales particulars have been prepared as a general guide only. A detailed survey has not been carried out, nor the services, appliances and fittings tested. Room sizes should not be relied upon for furnishing purposes and are approximate. If floor plans are included, they are for guidance only and illustration purposes only and may not be to scale. If there are any important matters likely to affect your decision to buy, please contact us before viewing the property.